

1. ~~DONT~~ CLOSE GATE ON LOYOLA

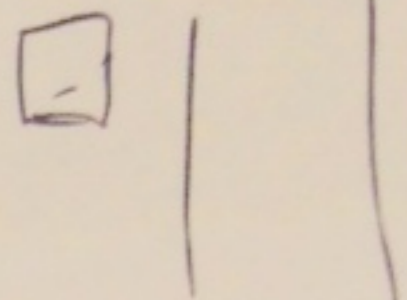

2. ~~AT DUSK~~ STREET LIGHTS

AT DUSK —

- STUDENTS - DARK CLOTHES  
QUEUES OF ROAD
- NO BICYCLE PATH ON ~~BOIS~~  
- SKATEBOARD PROBLEM ON STREET

SOLUTION: - CARS BACK ON CAMPUS

- STUDENTS WEAR REFLECTIVE VESTS - LOGO WEAR  
SELL THEM ON CAMPUS

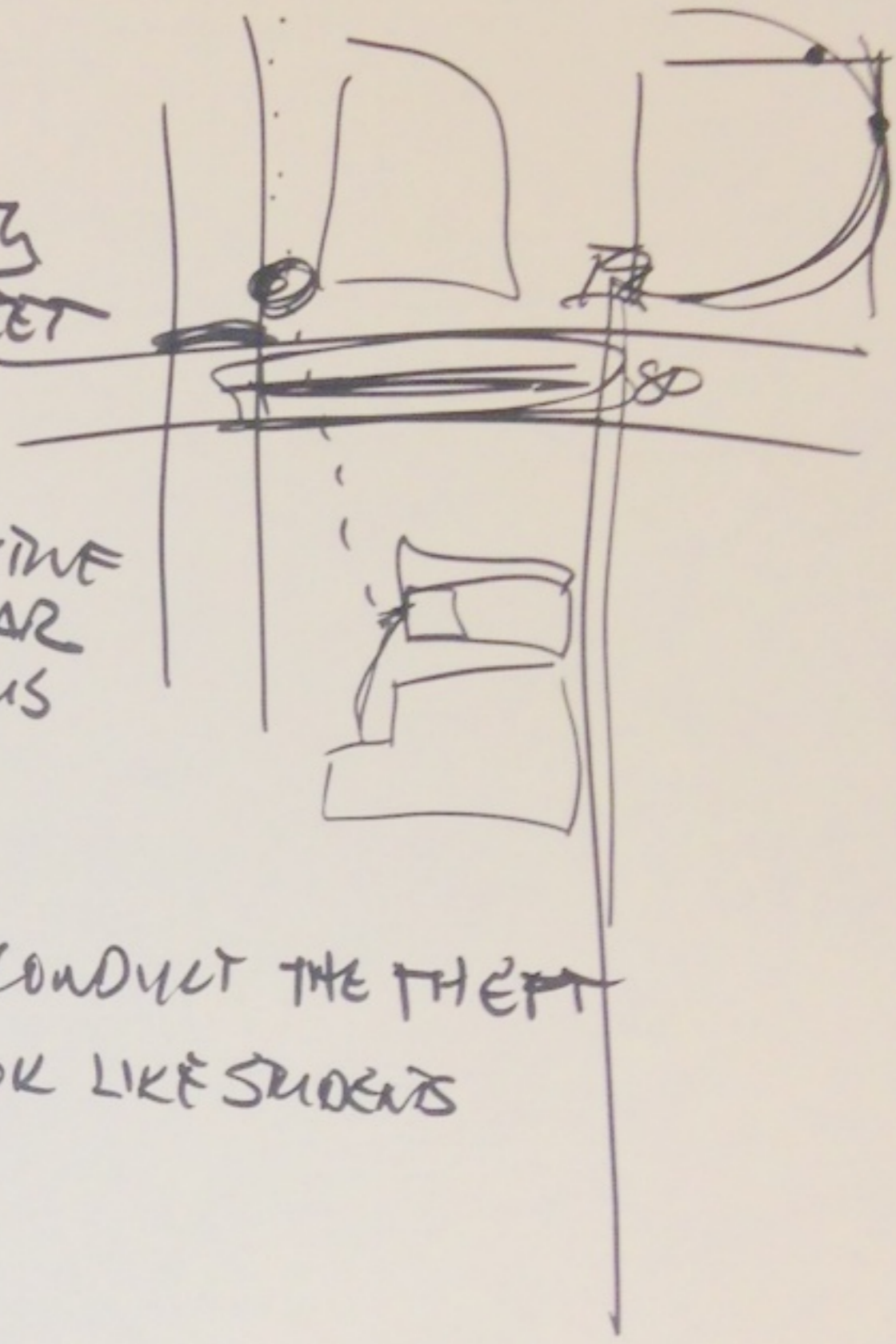

BREAKINS / BURGLARIES

- CELL PHONES - USING THEM TO CONDUCT THE THEFT
- BACK PACKS - USING FOR THEFTS - LOOK LIKE STUDENTS